



Ship & Industrial Service





Ship & Industrial Service

ABOUT US:

SIS is a new company specializing in the provision of manpower and services in the industrial, petrochemical and shipbuilding industry.

The members, staff and consultants come from important experiences in the shipbuilding industry, industrial and petrochemical.

The company's corporate facilities are located in Varna in Flotski Arsenal.

Finding experienced and qualified employees is a stressful, time-consuming, and expensive process.



Since its establishment SIS has been committed to help our clients with quick and cost-effective contract labor solutions that allow our customers to focus on the core goals and demands of their business.

SIS utilizes highly skilled teams of specialists and coordinators that cater to the unique needs of each client.

Finding experienced and qualified employees is a stressful, time-consuming, and expensive process.

All team come with proper English, French, Russian and German speaking supervisor and close management supervision.

All workers are fully trained, experienced, and come with complete insurance through SIS.

Our company has long experience in Industrial and ship work, in which deadlines and conditions change rapidly.

This is why service flexibility plays a key role.

Our clients can rest assured that every employee has been thoroughly tested for both aptitude and ability prior to placement



Ship & Industrial Service

SIS STRATEGY

Mission

Our objective is to provide products and services with the highest level of contents in terms of quality, safety and technical innovation to our customers with competitive prices

Starting from the very first steps of the engineering process, all the products will be designed and constructed according to the standards required by the customer and respecting high quality standards.

Values

As suggested by our experience, the best investment ever made is the knowhow and human resources, why we do everything possible, taking staff and suppliers at the lowest level possible to continuously increase this capital.

Vision

Our approach takes into account environmental and social impacts of our direct and indirect activities, from design to construction and assembly of products to order, up to maintenance and repairs on site.

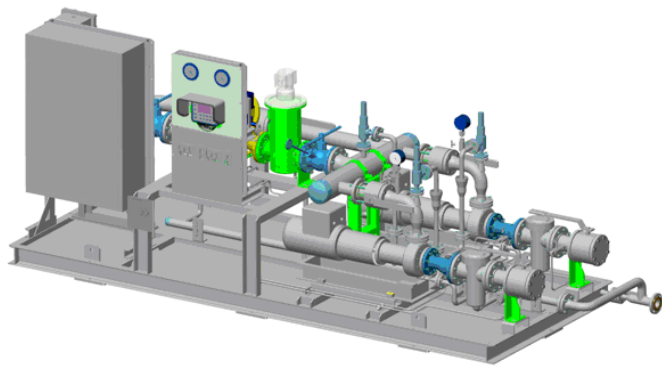

Why we believe that education and prevention of risks related to environmental conservation is essential for a sustainable growth and we make every effort to ensure the increasing trend taking particular attention to the negative effects that can cause an increase in both aspects: the people involved and the environment.

Business Strategy

Expansion of services in the petrochemical and shipbuilding industry.

Implementation the manufacturing chain so as to include as much phases as possible gaining the total control of the quality, the cost and the delivery times.

Development new markets significant for the business.

Economic Intent

Sustainability profitable policy: we believe that there's no use for a vertical growth without knowledge of the side effects that may harm a lot more and last for longer time than the advantage.

A great Customer experience should include a waste reduction, always.

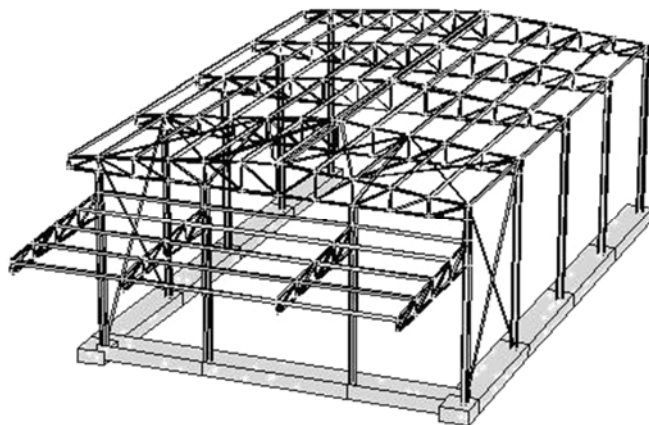

Ship & Industrial Service

BUSINESS CONCEPT

Perception

Products and Services planned to give the best:

Design, manufacturing assembly and services for Ship Repairs and Contractions, Oil & Gas engineering companies and final consumers in the ship and petrochemical industry which needs safe and high performance products designed and fabricated according to the several international standards and/or severe service conditions.

Service quality, service delivered matches customer expectations are our goals.

OUR SERVICES:

Onshore/Offshore

- Pipe system construction, installation and repairs with certified welders.
- Industrial and ship steel metal structural construction and repairs and steel replacement as per class requirements with certified welders and steel fabricators.
- Hydraulics systems repair and installation.
- Certified welder Team.
- Hulls builders team.
- Management of orders and maintenance work with our consultants and managers
- Team for blasting, painting and cosmetic upgrade of metal structure, pipes systems pipe lines, decks, tanks and cargo spaces observing all safety and quality requirements.
- Team for engine overhauls as per manufacturers requirements during dry-docking and conversions.
- Team for electrical installations and repairs.
- Team for scaffolding erection and insulation application/removal.
- Logistics and portorage services.
- Engineering solutions
- Consultancy & process development
- Feasibility studies
- Development & planning
- Construction
- Project management
- Manufacture
- Welding procedures design and testing
- Assembly
- Commissioning
- Documentation
- Quality management & assurance



We are always ready to get the job done.

Construction, installation and repairs with certified welders, steel fabricators, pipe fitters and mechanical.



Ship & Industrial Service

Products

Production and supplying and spare parts: TO DEVELOP AND MODIFY TO SUIT OUR NEEDS

- Pipe spooling and complete pipeline systems, construction, repair and replacement as per international standards requirements.
- Skids
- Metal structure, construction, repair and replacement as per international standards requirements
- Rolled Tubes and Cone-Shape d Reducers
- Individual tanks
- Vessel systems
- Pressure vessels
- Storage vessels for acids and bases
- Heat exchange
- Bridge drainage systems
- Hydraulics systems
- Marine spare parts production and supplying:
- Ventilation fans
- Cross pieces, cv joint (rods)
- Swivel, hose tale and water couplings
- Air ejectors
- Air vent heads
- Firefighting taps and couplings0
- Aluminum anodes
- Etc.



Competitiveness

Whilst guaranteeing that every single product is manufactured according to European norms and standards of quality, thanks to local low taxes and at a very competitive labor costs respect to the quality of manpower prices of our products and services are very competitive

The complete organization of contracts and the approach all the critical matters in the most cooperative and

professional environment, the meetings between engineers and workshop management and workers are a fundamental part of our business





Ship & Industrial Service

Quality Policy & Objectives

SIS quality policy is to achieve sustained, profitable growth by providing product and services that consistently satisfy the needs and expectations of our customers.

The required level of quality is achieved by implementation of a Quality Plan that reflects the competence of the Company to existing and potential customers.



This is achieved through the:

- Full commitment of all management and workforce to this quality policy, allied to active involvement in quality improvements.
- Understanding of all employees of the long-term importance of achieving customer satisfaction by providing a consistently high quality of product or service and conformance
- With statutory and regulatory requirements Skill, dedication and relevant working experience of staff.

The objectives of the Quality Assurance System are:

- Maintain an effective management system complying with statutory, technical, National and International Standards.
- Achieve and maintain a level of service and performance that enhances the Company's reputation with customers.
- Implementation of the Quality Plan involves all employees who are individually responsible for the quality of their work.
- Encourage a culture of flexibility, service, quality and continuous improvement.

Targets and measures are in place, which are reviewed and are compatible with this policy.

Customer Service Pledge

It is our goal is to provide the best customer support in the shipbuilding and industrial construction, before and after the sale.

We work towards that objective by treating customers honestly and fairly, by answering questions as rapidly and thoroughly as possible, and with the construction of a quality product which we feel proud to stand behind.

Business Model

- Be the low cost – high value producer
- Focus on innovation in products and services
- Collaborate with customers to craft unique solutions for their business needs

Value Chain

As a manufacturer of mechanical products and service providers, our added value index is very high by its nature since the production process start from plates, pipe or steel profile and ends with painted and packed or with the installation and commissioning, but, this is not a reason to limit our constantly increasing effort in actively collect feedback from the clients to determine how we can improve the product characteristics





Ship & Industrial Service

Contact:

Phone: +359 52 912 603

Fax: +359 52 912 602

Email:

office@sis.netai.net

technical@sis.netai.net

Web:

<http://www.sis.netai.net>

Address:

Str. Makedonia 142 Varna 9000, Bulgaria

